







# OUR PACKAGING WORKS AS WELL AS OUR TOOLS

Only Johnson Level offers you three distinct product grades and price points. Convenient color coding, photography and our exclusive, vial grading scale assure fast and appropriate tool selection: **STANDARD™** (Good), **PROJECT™** (Better) and **CONTRACTOR™** (Best, with a "Lifetime Guarantee"). Johnson packaging is more complete, concise, consistent and customer-friendly.

Made In USA logo proudly displayed

Photography guides consumer to appropriate tool series for their work



Full-color, educational "how-to" illustrations on back

Quick read, sell copy on back answers questions most frequently asked

Tool name and key descriptive text in English, French and Spanish

Unique vial tool-grading scale

## CONTRACTOR



Top of the line, professional grade durability backed by Johnson's "lifetime guarantee."

## PROJECT

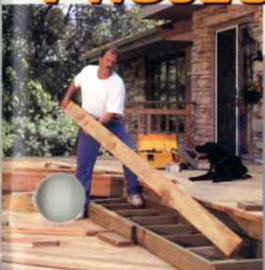

Serious performance for the experienced do-it-yourselfer.

## STANDARD

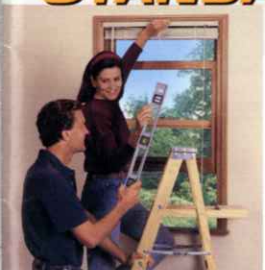

Reliable, versatile and affordable tools for everyday jobs around the home.

## CONTENTS

### LEVELS

|                            |         |
|----------------------------|---------|
| WOOD LEVELS.....           | 2,3     |
| ALUMINUM LEVELS.....       | 3,4,5,6 |
| PLASTIC LEVELS & CASE..... | 7       |
| TORPEDO LEVELS.....        | 8,9     |
| LINE & SURFACE LEVELS..... | 10      |
| SPECIALTY LEVELS.....      | 11,12   |

### SQUARES

|                                     |       |
|-------------------------------------|-------|
| CARPENTER/RAFTER SQUARES.....       | 13    |
| RAFTER ANGLE SQUARES.....           | 14    |
| COMBINATION SQUARES.....            | 15    |
| TRY SQUARES & SLIDING T-BEVELS..... | 16    |
| DRYWALL SQUARES.....                | 17,18 |

### MEASURING & MARKING TOOLS

|                             |       |
|-----------------------------|-------|
| RULES & STRAIGHT EDGES..... | 19,20 |
| PLUMB BOBS & SAWS.....      | 21    |
| SPECIALTY TOOLS.....        | 22    |
| CRAYONS & PENCILS.....      | 23    |
| FLAGS & TAPES.....          | 24    |



# LEVELS



9500 SERIES

## CONTRACTOR MAGNETIC ALUMINUM BOX BEAM LEVELS

*Construction:* Extruded aluminum box beam profile with convenient hand holes. Stronger redesigned magnetic surface. Yellow powder coat finish. Precision machined leveling edges. Solid machined acrylic yellow vials with interior permanent vial markings. Shock-protecting end caps. Frame dimension: 1" x 2 5/16".

*Applications:* A top-of-the line "European design" box beam level for any level and plumb applications. The most durable of all aluminum levels. Hands-free leveling on ferrous materials. Highly accurate and sensitive.

| Catalog Number | Length | Total Vial Count | Level Vial Count | Plumb Vial Count |
|----------------|--------|------------------|------------------|------------------|
| c 9524-HH      | 24"    | 3                | 1                | 2                |
| c 9548-HH      | 48"    | 3                | 1                | 2                |
| c 9572-HH      | 72"    | 3                | 1                | 2                |
| c 9578-HH      | 78"    | 3                | 1                | 2                |



9600 SERIES

## PROJECT ALUMINUM BOX BEAM LEVELS

*Construction:* Extruded aluminum box beam profile with clear (silver) anodized finish. Solid machined acrylic yellow vials with permanent interior vial markings. Shock-protecting end caps. Frame dimension: 1 3/16" x 1 15/16"; 72" is 1 5/16" x 1 15/16".

*Applications:* A mid-range "European design" box beam frame for any general level/plumb applications. More accurate and durable than I-beam levels.

| Catalog Number | Length | Total Vial Count | Level Vial Count | Plumb Vial Count |
|----------------|--------|------------------|------------------|------------------|
| 9624           | 24"    | 3                | 1                | 2                |
| 9648           | 48"    | 3                | 1                | 2                |
| 9672           | 72"    | 3                | 1                | 2                |



9700 SERIES

## PROJECT MAGNETIC ALUMINUM BOX BEAM LEVELS

*Construction:* Extruded aluminum box beam profile with clear (silver) anodized finish. Strong full-length magnetic edge. Solid machined acrylic yellow vials with interior permanent vial markings. Shock-protecting end caps. Frame dimension: 1 3/16" x 1 15/16".

*Applications:* A mid-range "European design" box beam frame for any general level/plumb applications. More accurate and durable than I-beam levels. Hands-free leveling on ferrous materials.

| Catalog Number | Length | Total Vial Count | Level Vial Count | Plumb Vial Count |
|----------------|--------|------------------|------------------|------------------|
| c 9724         | 24"    | 3                | 1                | 2                |
| c 9748         | 48"    | 3                | 1                | 2                |



## 4600 SERIES

### CONTRACTOR

## HEAVY DUTY DUAL-VIAL ALUMINUM LEVELS

*Construction:* Large heavy-duty extruded aluminum I-beam frame. Hi-visibility bright red anodized finish. Independently calibrated dual-curved yellow vials per sight with protective Lexan\* lenses. Shock-protecting end caps. Frame dimension: 1 1/16" x 2 1/2".

*Applications:* Heavy-duty construction, building, remodeling where durability is a factor— an ideal level where longer lengths are needed.

| Catalog Number | Length | Total Vial Count | Level Vial Count | Plumb Vial Count |
|----------------|--------|------------------|------------------|------------------|
| 4624           | 24"    | 6                | 2                | 4                |
| 4648           | 48"    | 6                | 2                | 4                |
| 4672           | 72"    | 10               | 4                | 6                |
| 4696           | 96"    | 10               | 4                | 6                |



## 3700 SERIES

### CONTRACTOR

## MACHINED TOP-READ ALUMINUM LEVELS

*Construction:* Extruded aluminum I-beam frame with black anodized finish. Computer machined level edges. 360 degree reading acrylic yellow barrel vials. Screw on high impact plastic covers with protective lenses. Large, patented, magnified top-read window. Shock-protecting end caps. Frame dimension: 1" x 2 1/4".

*Applications:* The top-of-the-line barrel vial aluminum level for more accurate applications in level and plumb.

| Catalog Number | Length | Total Vial Count | Level Vial Count | Plumb Vial Count |
|----------------|--------|------------------|------------------|------------------|
| 3718           | 18"    | 3                | 1                | 2                |
| 3724           | 24"    | 3                | 1                | 2                |
| 3736           | 36"    | 3                | 1                | 2                |
| 3748           | 48"    | 3                | 1                | 2                |
| 3772           | 72"    | 5                | 2                | 3                |
| 3778           | 78"    | 5                | 2                | 3                |
| 3796           | 96"    | 5                | 2                | 3                |

U.S. Patent No. 5,105,549



## 3800 SERIES

### CONTRACTOR

## MAGNETIC MACHINED TOP-READ ALUMINUM LEVELS

*Construction:* Extruded aluminum I-beam frame with black anodized finish. Computer machined level edges. Strong, full-length magnetic strip. 360 degree reading acrylic yellow barrel vials. Screw on high impact plastic covers with protective lenses. Large, patented, magnified top-read window. Shock-protecting end caps. Frame dimension: 1" x 2 1/4".

*Applications:* The top-of-the-line barrel vial aluminum level for more accurate applications in level and plumb. Hands-free leveling on ferrous materials.

| Catalog Number | Length | Total Vial Count | Level Vial Count | Plumb Vial Count |
|----------------|--------|------------------|------------------|------------------|
| 3818           | 18"    | 3                | 1                | 2                |
| 3824           | 24"    | 3                | 1                | 2                |
| 3836           | 36"    | 3                | 1                | 2                |
| 3848           | 48"    | 3                | 1                | 2                |
| 3872           | 72"    | 5                | 2                | 3                |
| 3878           | 78"    | 5                | 2                | 3                |
| 3896           | 96"    | 5                | 2                | 3                |

U.S. Patent No. 5,105,549

\*Lexan is a registered trademark of General Electric.

# LEVELS



**1200 SERIES**  
**1300 SERIES**

**PROJECT**

## TOP-READ ALUMINUM LEVELS WITH RULE

*Construction:* Extruded aluminum midsize frame with clear (silver) anodized finish. Ruled edge in 1/8ths, 1/16ths and cm. 360 degree reading acrylic yellow barrel vials with Quik-Change® one-piece replaceable high impact plastic covers and lenses. Top-reading window available on 1300 series. Shock-protecting end caps. Frame dimension: 1" x 2 1/8".

*Applications:* A mid-range "do-it-yourself" level for general around-the-house projects, and light construction uses.

| Catalog Number | Length | Total Vial Count | Level Vial Count | Plumb Vial Count | Graduations                   |
|----------------|--------|------------------|------------------|------------------|-------------------------------|
| 1218           | 18"    | 2                | 1                | 1                | 1/8", 1/16", cm (no top-read) |
| 1318           | 18"    | 3                | 1                | 2                | 1/8", 1/16", cm               |
| 1224           | 24"    | 2                | 1                | 1                | 1/8", 1/16", cm (no top-read) |
| 1324           | 24"    | 3                | 1                | 2                | 1/8", 1/16", cm               |
| 1328           | 28"    | 3                | 1                | 2                | 1/8", 1/16", cm               |
| 1336           | 36"    | 3                | 1                | 2                | 1/8", 1/16", cm               |
| 1348           | 48"    | 3                | 1                | 2                | 1/8", 1/16", cm               |
| 1472           | 72"    | 4                | 2                | 2                | (no rule)                     |

U.S. Patent No. 4,996,777, Canadian Patent No. 2,022,528



**1700 SERIES**

**PROJECT**

## MAGNETIC TOP-READ ALUMINUM LEVELS

*Construction:* Extruded aluminum midsize frame with clear (silver) anodized finish. Strong, full-length magnetic strip. 360 degree reading acrylic yellow barrel vials with Quik-Change® one-piece replaceable high impact plastic covers and lenses. Top-reading window. Shock-protecting end caps. Frame dimension: 1" x 2 1/4".

*Applications:* A mid-range "do-it-yourself" level for general around-the-house projects. Hands-free leveling on ferrous materials.

| Catalog Number | Length | Total Vial Count | Level Vial Count | Plumb Vial Count |
|----------------|--------|------------------|------------------|------------------|
| 1724           | 24"    | 3                | 1                | 2                |
| 1748           | 48"    | 3                | 1                | 2                |
| 1772           | 72"    | 4                | 2                | 2                |

U.S. Patent No. 4,996,777, Canadian Patent No. 2,022,528

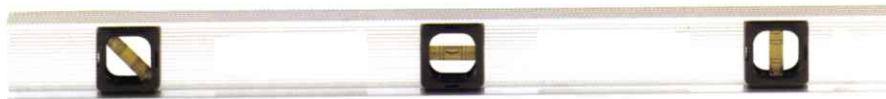

**STANDARD SERIES**

**STANDARD**

## ALUMINUM LEVELS

*Construction:* Inexpensive, lightweight aluminum extruded I-beam frame. V-groove edge to accommodate round surfaces. 360 degree reading acrylic yellow barrel vials. One-piece Quik-Change® replaceable high impact plastic vial covers (no lenses). Frame dimension: 7/8" x 2 1/8".

*Applications:* An inexpensive, lightweight level for any "entry level" project around-the-house.

| Catalog Number | Length | Total Vial Count | Level Vial Count | Plumb Vial Count | 45° Vial Count |
|----------------|--------|------------------|------------------|------------------|----------------|
| 122            | 12"    | 2                | 1                | 1                | -              |
| 182            | 18"    | 2                | 1                | 1                | -              |
| 183            | 18"    | 3                | 1                | 1                | 1              |
| 242            | 24"    | 2                | 1                | 1                | -              |
| 243            | 24"    | 3                | 1                | 1                | 1              |
| 363            | 36"    | 3                | 1                | 1                | 1              |
| 483            | 48"    | 3                | 1                | 1                | 1              |

U.S. Patent No. 4,996,777, Canadian Patent No. 2,022,528





## 7700 SERIES

### STANDARD

## STRUCTO-CAST® LEVELS WITH RULE

**Construction:** One-piece, injection molded structural-foam plastic frame. Ruled edge in 1/8ths, 1/16ths and mm. 360 degree reading acrylic yellow barrel vials. One-piece Quik-Change® replaceable high impact plastic vial covers (no lenses). Frame dimension: 14"- 24"; 1"x 2 1/4"; 36"- 48"; 1 1/4" x 2 1/4".

**Applications:** A lightweight, inexpensive, non-marring level for around-the-house projects.

| Catalog Number | Length | Total Vial Count | Level Vial Count | Plumb Vial Count | 45° Vial Count | Graduations     | Color      |
|----------------|--------|------------------|------------------|------------------|----------------|-----------------|------------|
| 7714           | 14"    | 2                | 1                | 1                | —              | 1/8", 1/16", mm | Gray       |
| 7714-Y         | 14"    | 2                | 1                | 1                | —              | 1/8", 1/16", mm | Glo-Yellow |
| 7714-L         | 14"    | 2                | 1                | 1                | —              | 1/8", 1/16", mm | Glo-Lime   |
| 7718           | 18"    | 3                | 1                | 1                | 1              | 1/8", 1/16", mm | Gray       |
| 7718-Y         | 18"    | 3                | 1                | 1                | 1              | 1/8", 1/16", mm | Glo-Yellow |
| 7718-L         | 18"    | 3                | 1                | 1                | 1              | 1/8", 1/16", mm | Glo-Lime   |
| 7724           | 24"    | 3                | 1                | 1                | 1              | 1/8", 1/16", mm | Gray       |
| 7724-Y         | 24"    | 3                | 1                | 1                | 1              | 1/8", 1/16", mm | Glo-Yellow |
| 7724-L         | 24"    | 3                | 1                | 1                | 1              | 1/8", 1/16", mm | Glo-Lime   |
| 7736           | 36"    | 3                | 1                | 1                | 1              | 1/8", 1/16", mm | Gray       |
| 7736-Y         | 36"    | 3                | 1                | 1                | 1              | 1/8", 1/16", mm | Glo-Yellow |
| 7736-L         | 36"    | 3                | 1                | 1                | 1              | 1/8", 1/16", mm | Glo-Lime   |
| 7748           | 48"    | 3                | 1                | 1                | 1              | 1/8", 1/16", mm | Gray       |
| 7748-Y         | 48"    | 3                | 1                | 1                | 1              | 1/8", 1/16", mm | Glo-Yellow |
| 7748-L         | 48"    | 3                | 1                | 1                | 1              | 1/8", 1/16", mm | Glo-Lime   |

U.S. Patent No. 4,996,777, Canadian Patent No. 2,022,528

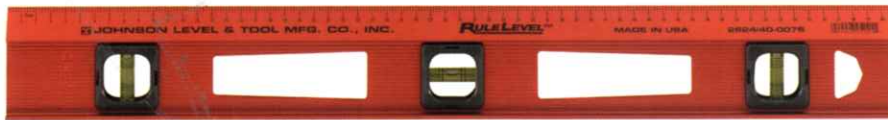

## 2500 SERIES

## 2600 SERIES

### PROJECT

## ALUMINUM RULELEVEL™

**Construction:** Bright red anodized triangular shaped aluminum frame. Convenient screen-printed ruled edge in 1/8ths or mm. 360 degree reading acrylic yellow barrel vials. One-piece Quik-Change® replaceable high impact plastic vial covers (no lenses). Frame dimension: 1" x 2 13/16".

**Applications:** Measure, layout, and level: all with one tool. Perfect for wallpapering, or hanging pictures and shelving.

| Catalog Number | Length | Total Vial Count | Level Vial Count | Plumb Vial Count | Graduations |
|----------------|--------|------------------|------------------|------------------|-------------|
| 2524           | 24"    | 3                | 1                | 2                | 1/8"        |
| 2536           | 36"    | 3                | 1                | 2                | 1/8"        |
| 2548           | 48"    | 3                | 1                | 2                | 1/8"        |
| 2624           | 24"    | 3                | 1                | 2                | mm          |
| 2636           | 36"    | 3                | 1                | 2                | mm          |
| 2648           | 48"    | 3                | 1                | 2                | mm          |

U.S. Patent No. 4,996,777, Canadian Patent No. 2,022,528



## Level-Guard LEVEL CASE

**Construction:** High-density polypropylene blow-molded in hi-visibility orange. Removable, snap-on cap. Four exclusive gussets internally protect level.

**Applications:** To transport and protect any 48" level, particularly with glass lenses. Fits most standard levels.

| Catalog Number | Length |
|----------------|--------|
| LC48           | 48"    |

U.S. Patent Nos. 5,119,936 & 5,263,584  
Canadian Patent No. 2,041,423

# TORPEDO LEVELS



## CONTRACTOR

### ALUMINUM TORPEDO LEVEL

*Construction:* One-piece, full-length cast aluminum frame with exclusive CNC machined edges. 360 degree reading acrylic yellow barrel vials. High impact plastic covers. Large v-grooved edge to accommodate pipe and conduit. Level vial is top-reading.

| Catalog Number | Length | Level Vial Count | Plumb Vial Count | 45° Vial Count |
|----------------|--------|------------------|------------------|----------------|
| 6500           | 9"     | 1                | 1                | 1              |

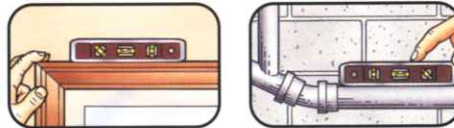

## CONTRACTOR

### MAGNETIC ALUMINUM TORPEDO LEVEL

*Construction:* One-piece, full-length cast aluminum frame with exclusive CNC machined edges. 360 degree reading acrylic yellow barrel vials. High impact plastic covers. Large v-grooved edge to accommodate pipe and conduit. Level vial is top-reading. Extra strong, full-length magnetic edge.

| Catalog Number | Length | Level Vial Count | Plumb Vial Count | 45° Vial Count |
|----------------|--------|------------------|------------------|----------------|
| 6500M          | 9"     | 1                | 1                | 1              |

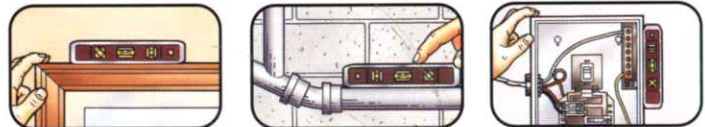

## PROJECT

### MAGNETIC ALUMINUM TORPEDO LEVEL

*Construction:* Extruded aluminum frame with high impact plastic covers. 360 degree reading acrylic yellow barrel vials. Level vial is top-reading. V-grooved edge. Full-length magnetic edge.

| Catalog Number | Length | Level Vial Count | Plumb Vial Count | 45° Vial Count |
|----------------|--------|------------------|------------------|----------------|
| 8500M          | 9"     | 1                | 1                | 1              |

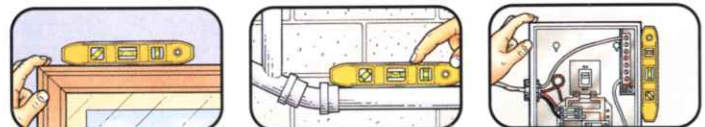





**STANDARD**  
**STRUCTO-CAST® TORPEDO LEVELS**

*Construction:* Durable high impact plastic molded frame and covers. 360 degree reading acrylic yellow barrel vials. Level vial is top-reading. V-grooved edge.

| Catalog Number | Length | Level Vial Count | Plumb Vial Count | 45° Vial Count | Color      |
|----------------|--------|------------------|------------------|----------------|------------|
| 7500           | 9"     | 1                | 1                | 1              | Gray       |
| 7500B-GRAY     | 9"     | 1                | 1                | 1              | Gray       |
| 7500B-ORANGE   | 9"     | 1                | 1                | 1              | Glo-Orange |
| 7500B-LIME     | 9"     | 1                | 1                | 1              | Glo-Lime   |

"B" designates item shipped bulk packed — no P.O.P. packaging

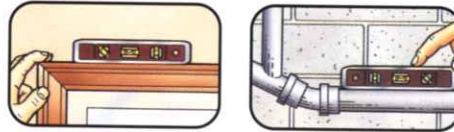

**STANDARD**  
**MAGNETIC®**  
**STRUCTO-CAST® TORPEDO LEVELS**

*Construction:* Durable high impact plastic molded frame and covers. 360 degree reading acrylic yellow barrel vials. Level vial is top-reading. V-grooved edge. Full-length magnetic edge.

| Catalog Number | Length | Level Vial Count | Plumb Vial Count | 45° Vial Count | Color      |
|----------------|--------|------------------|------------------|----------------|------------|
| 7500M          | 9"     | 1                | 1                | 1              | Maroon     |
| 7500MB-RED     | 9"     | 1                | 1                | 1              | Maroon     |
| 7500MB-ORANG   | 9"     | 1                | 1                | 1              | Glo-Orange |
| 7500MB-LIME    | 9"     | 1                | 1                | 1              | Glo-Lime   |

"B" designates item shipped bulk packed — no P.O.P. packaging



# LINE & SURFACE LEVELS



**CONTRACTOR**  
**ALUMINUM LINE LEVEL**

*Construction:* Hexagonal aluminum extruded body. Durable high impact plastic reversed line hooks. Acrylic yellow barrel vial.

| Catalog Number | Length | Total Vial Count |
|----------------|--------|------------------|
| 555            | 3"     | 1                |

U.S. Patent No. 5,659,967, Foreign patent pending

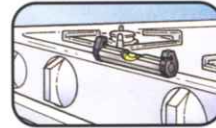
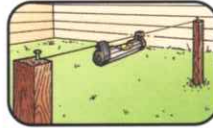

**PROJECT**  
**STRUCTO-CAST® LINE LEVELS**

*Construction:* Lightweight, durable high impact plastic ends. 360 degree reading acrylic yellow barrel vial. Reversed line hooks. Convenient pocket clip.

| Catalog Number | Length | Total Vial Count | Color    | Pack   |
|----------------|--------|------------------|----------|--------|
| 575            | 3"     | 1                | Black    | 1/card |
| 585            | 3"     | 1                | Glo-Lime | 2/card |

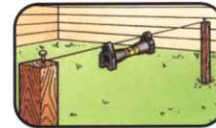

**PROJECT**  
**CROSS CHECK LEVEL**

*Construction:* High impact plastic body. Two acrylic yellow barrel vials. Mounting holes.

| Catalog Number | Length | Total Vial Count |
|----------------|--------|------------------|
| 125            | 2 1/4" | 2                |

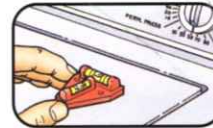

**PROJECT**  
**BULL'S-EYE™ LEVEL**

*Construction:* Acrylic plastic body. Mounting holes.

| Catalog Number | Diameter | Total Vial Count |
|----------------|----------|------------------|
| 100            | 1 3/4"   | 1                |

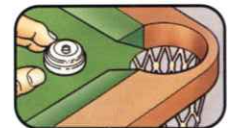
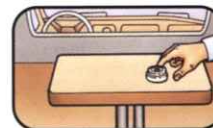



# SPECIALTY LEVELS



## PROJECT

### POCKET LEVEL WITH MAGNETIC PICK-UP

*Construction:* High impact plastic body with metal pocket clip. Acrylic yellow barrel vial. Strong magnetic pick-up. V-grooved edge.

| Catalog Number | Length | Total Vial Count |
|----------------|--------|------------------|
| 500            | 5"     | 1                |

U.S. Patent Nos. 6,026,581 & D385,807

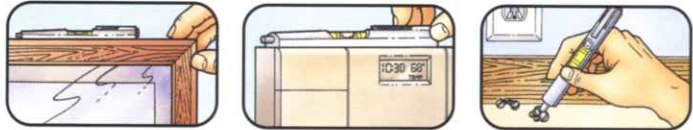

## CONTRACTOR

### MAGNETIC ANGLE LOCATOR

*Construction:* High impact plastic body in hi-visibility orange. Clear acrylic lens with easy-to-read increments in 0-90 degrees in four quadrants. V-grooved edge. Extra strong permanent ceramic magnet. Convenient metric rule on one edge, and English rule on the other.

| Catalog Number | Diameter |
|----------------|----------|
| 700            | 5 7/8"   |

U.S. Patent No. D389,755

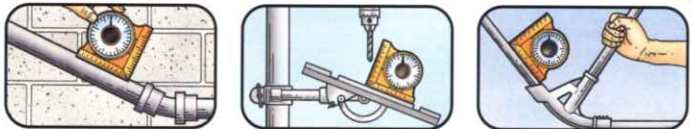

## CONTRACTOR

### PITCH & SLOPE LOCATOR

*Construction:* High impact plastic body in black. Clear acrylic lens with easy-to-read graduations. Half of scale is printed in 0-90 degrees in two quadrants. Other half is a patented printed scale to read pitch in inch rise per 12" run without the use of conversion tables.

| Catalog Number | Diameter |
|----------------|----------|
| 750            | 5 3/8"   |

U.S. Patent Nos. D389,756 & 5,937,371

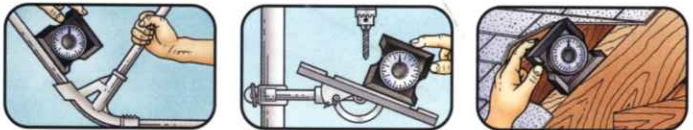

## PROJECT

### WATER LEVEL

*Construction:* Two clear plastic tubes with pop-up end caps. Threaded male and female coupler ends. Handy shut-off valve. Use with any length standard garden hose.

| Catalog Number | Length |
|----------------|--------|
| 2120           | 14"    |

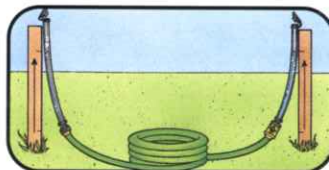

# SPECIALTY LEVELS



## CONTRACTOR POST LEVELS

*Construction:* Durable high impact plastic body. Acrylic yellow barrel vials with patented white reflective backer plates enables vials to be easily read. Strap permanently affixed to one end to eliminate loss. Quickly and easily hooks to any post, pole or stringer. Magnetic version available.

| Catalog Number | Size            | Total Vial Count | Color      |
|----------------|-----------------|------------------|------------|
| 175            | 5 1/2" x 3 1/2" | 3                | Gray       |
| 175B-GRAY      | 5 1/2" x 3 1/2" | 3                | Gray       |
| 175B-ORANGE    | 5 1/2" x 3 1/2" | 3                | Glo-Orange |
| 175B-LIME      | 5 1/2" x 3 1/2" | 3                | Glo-Lime   |
| 175M           | 5 1/2" x 3 1/2" | 3                | Gray       |

"B" designates item shipped bulk packed — no P.O.P. packaging  
"M" designates magnetic version

U.S. Patent Nos. 5,207,004 & D332,058  
Foreign patent pending

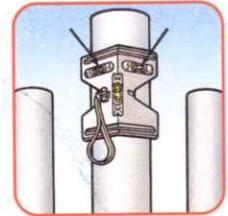
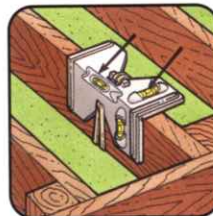

MAGNETIC



## CONTRACTOR HAND HELD SIGHT LEVEL

*Construction:* Durable high impact plastic hi-visibility orange body. Accurate cross-hair sighting. Single power vision.

| Catalog Number | Length |
|----------------|--------|
| 80-5556        | 4 3/4" |

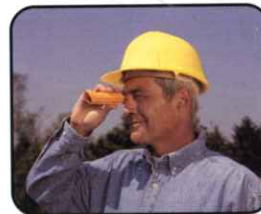

## PROJECT STUD FINDER PLUS™

*Construction:* Durable high impact plastic base with clear acrylic lens. Strong magnet. Acrylic yellow barrel vial.

| Catalog Number | Length          |
|----------------|-----------------|
| 160            | 1 5/8" x 3 1/4" |

U.S. Patent Nos. 5,148,108 & D339,074  
Australian Patent No. 649,820  
Canadian Patent No. 2,106,085

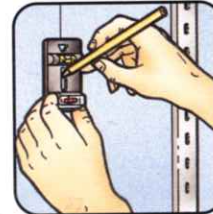



# CARPENTER & RAFTER SQUARES

## CONTRACTOR

### STEEL RAFTER SQUARE

Construction: Permanent 1/8" stamped graduations include rafter square layout with tables and essex board measure. Rust protective coating.

| Catalog Number | Size      | Material | Graduations |
|----------------|-----------|----------|-------------|
| CS2            | 16" x 24" | Steel    | 1/8"        |

## CONTRACTOR

### ALUMINUM RAFTER SQUARES

Construction: Permanent 1/8" stamped graduations include rafter square layout with tables and essex board measure. Clear (silver) anodized finish. CS7 is black anodized finish with yellow filled graduations.

| Catalog Number | Size      | Material | Graduations |
|----------------|-----------|----------|-------------|
| CS5            | 16" x 24" | Aluminum | 1/8"        |
| CS7            | 16" x 24" | Aluminum | 1/8"        |

## PROJECT

### STEEL CARPENTER SQUARES

Construction: Permanent 1/8" stamped graduations. Rust protective coating. CS3 version available in mm.

| Catalog Number | Size      | Material | Graduations |
|----------------|-----------|----------|-------------|
| CS1            | 16" x 24" | Steel    | 1/8"        |
| CS3            | 16" x 24" | Steel    | mm          |
| 430            | 8" x 12"  | Steel    | 1/8"        |

## PROJECT

### ALUMINUM CARPENTER SQUARE

Construction: Permanent 1/8" stamped graduations. Clear (silver) anodized finish.

| Catalog Number | Size      | Material | Graduations |
|----------------|-----------|----------|-------------|
| CS4            | 16" x 24" | Aluminum | 1/8"        |



## CONTRACTOR

### BRASS STAIR/SQUARE GAUGES

Construction: Machined solid brass with knurled screws.

| Catalog Number | Pack   |
|----------------|--------|
| 405            | 2/card |

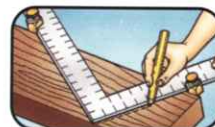
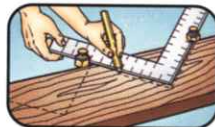

# RAFTER ANGLE SQUARES



## CONTRACTOR 7" ALUMINUM RAFTER ANGLE SQUARES

*Construction:* Solid aluminum cast body with exclusive CNC computer machined edges. Permanent molded graduations. Low-glare, protective powder coat finish. Complete instruction manual included (except bulk version).

| Catalog Number | Size |
|----------------|------|
| RAS-1          | 7"   |
| RAS-1B         | 7"   |

"B" designates item shipped bulk packed — no P.O.P. packaging

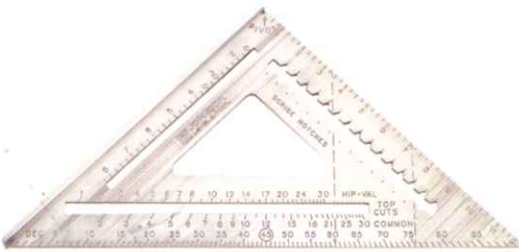
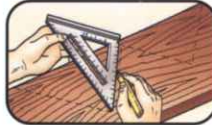

## CONTRACTOR 12" ALUMINUM RAFTER ANGLE SQUARE

*Construction:* Solid aluminum cast body with exclusive CNC computer machined edges. Permanent molded graduations. Low-glare, protective powder coat finish. Complete instruction manual included.

| Catalog Number | Size |
|----------------|------|
| RAS-120        | 12"  |

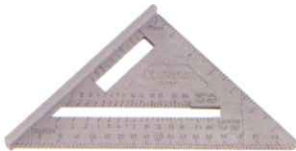

## PROJECT 7" **STRUCTO-CAST** RAFTER ANGLE SQUARES

*Construction:* One-piece high impact plastic. Permanent molded graduations. Complete instruction manual included (except bulk version).

| Catalog Number | Size | Color      |
|----------------|------|------------|
| RAS-70         | 7"   | Gray       |
| RAS-70B-GRAY   | 7"   | Gray       |
| RAS-70B-ORAN   | 7"   | Glo-Orange |
| RAS-70B-LIME   | 7"   | Glo-Lime   |

"B" designates item shipped bulk packed — no P.O.P. packaging



# COMBINATION SQUARES



## CONTRACTOR METAL COMBINATION SQUARE

*Construction:* Cast zinc head with computer machined gauging edges for greater accuracy. Acrylic yellow barrel vial. Hardened removable scribe. Aluminum alloy blade is etched in 1/8 ths, 1/16 ths, 1/32 nds, and mm.

| Catalog Number | Size | Head Material | Graduations            |
|----------------|------|---------------|------------------------|
| 406EM          | 6"   | Zinc          | 1/8", 1/16", 1/32", mm |



## CONTRACTOR METAL COMBINATION SQUARES

*Construction:* Cast zinc head with computer machined gauging edges for greater accuracy. Acrylic yellow barrel vial. Hardened removable scribe. Steel blades are permanently stamped in 1/8 ths, 1/16 ths, and 1/32 nds with rust protective coating. Also available in metric (1/8 ths, 1/16 ths, 1/32 nds, and mm). 420EM blade is stamped in 1/8" and mm.

| Catalog Number | Size | Head Material | Graduations            |
|----------------|------|---------------|------------------------|
| 400            | 12"  | Zinc          | 1/8", 1/16", 1/32"     |
| 400EM          | 12"  | Zinc          | 1/8", 1/16", 1/32", mm |
| 420EM          | 16"  | Zinc          | 1/8", mm               |



## CONTRACTOR METAL COMBINATION SQUARES

*Construction:* Cast iron head. Acrylic yellow barrel vial. Hardened removable scribe. Steel blades are permanently stamped in 1/8 ths, 1/16 ths, and 1/32 nds with rust protective coating. Also available in metric (1/8 ths, 1/16 ths, 1/32 nds, and mm).

| Catalog Number | Size | Head Material | Graduations            |
|----------------|------|---------------|------------------------|
| 440            | 12"  | Cast Iron     | 1/8", 1/16", 1/32"     |
| 440EM          | 12"  | Cast Iron     | 1/8", 1/16", 1/32", mm |

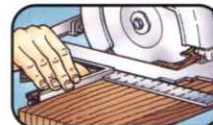

## PROJECT STRUCTO-CAST® COMBINATION SQUARES

*Construction:* High impact plastic head. Acrylic yellow barrel vial. Stamped steel blades in 1/8 ths, 1/16 ths, and 1/32 nds with rust protective coating. Also available in metric (1/8 ths, 1/16 ths, 1/32 nds, and mm).

| Catalog Number | Size | Head Material | Graduations            |
|----------------|------|---------------|------------------------|
| 415            | 12"  | Plastic       | 1/8", 1/16", 1/32"     |
| 415EM          | 12"  | Plastic       | 1/8", 1/16", 1/32", mm |

# TRY SQUARES & SLIDING T-BEVELS



**CONTRACTOR**  
**HARDWOOD TRY SQUARE**

*Construction:* No. 1 select hardwood handle with brass gauging edges and routed hand grip. Stainless steel blade with easy-to-read etched increments in  $\frac{1}{8}$  ths and  $\frac{1}{16}$  ths.

| Catalog Number | Size | Graduations                       |
|----------------|------|-----------------------------------|
| 480            | 8"   | $\frac{1}{8}$ ", $\frac{1}{16}$ " |



**PROJECT**  
**STRUCTO-CAST® TRY & MITRE SQUARES**

*Construction:* High impact plastic handle with hand grip and insert-molded blade. Stainless steel blade with permanent stamped graduations in  $\frac{1}{8}$  ths. Metric version available in  $\frac{1}{8}$ " and mm graduations.

| Catalog Number | Size | Graduations         |
|----------------|------|---------------------|
| 450            | 8"   | $\frac{1}{8}$ "     |
| 451            | 8"   | $\frac{1}{8}$ ", mm |



**CONTRACTOR**  
**HARDWOOD SLIDING T-BEVEL**

*Construction:* No. 1 select hardwood handle with routed hand grip and brass edging. Stainless steel blade with wing-nut fastener.

| Catalog Number | Size |
|----------------|------|
| B85            | 8"   |



**PROJECT**  
**STRUCTO-CAST® SLIDING T-BEVEL**

*Construction:* Durable high impact plastic handle with hand grip. Stainless steel blade with wing-nut fastener.

| Catalog Number | Size |
|----------------|------|
| B75            | 8"   |



# DRYWALL SQUARES



## CONTRACTOR

### ALUMINUM ADJUST-A-SQUARE®

*Construction:* Heavy-duty extruded aluminum blade with clear (silver) anodized finish. Screened thermal bonded graduations in black (48" in 1/8ths and 1/16ths; 54" in 1/8ths). Precision machined head and blade lock together for perfect 90 degree. Head adjusts to any angle. Folds flat for easy transport. 54" length also available.

| Catalog Number | Size | Graduations |
|----------------|------|-------------|
| ADS48          | 48"  | 1/8", 1/16" |
| ADS54          | 54"  | 1/8"        |

U.S. Patent No. 4,525,933

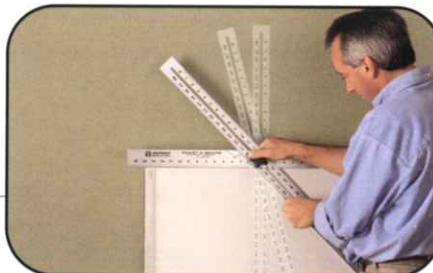

## CONTRACTOR

### ALUMINUM DRYWALL T-SQUARES

*Construction:* Extruded aluminum blade and head with clear (silver) anodized finish. Screened thermal bonded 1/8" graduations in black. Exclusive designed solid four-rivet construction permanently "bonds" head to blade.

| Catalog Number | Size | Graduations | Pack   |
|----------------|------|-------------|--------|
| JTS48          | 48"  | 1/8"        | 2/pack |
| JTS481         | 48"  | 1/8"        | 1/pack |

## CONTRACTOR

### METRIC ALUMINUM DRYWALL T-SQUARE

*Construction:* Extruded aluminum blade and head with clear (silver) anodized finish. Screened thermal bonded mm graduations in black. Exclusive designed solid four-rivet construction permanently "bonds" head to blade.

| Catalog Number | Size   | Graduations |
|----------------|--------|-------------|
| JTS1200        | 1200mm | mm          |

# DRYWALL SQUARES



## CONTRACTOR

### HEAVY DUTY ALUMINUM DRYWALL T-SQUARES

*Construction:* Heavy-duty extruded aluminum blade and head with clear (silver) anodized finish. Screened thermal bonded 1/8" graduations in black. Exclusive designed solid four-rivet construction permanently "bonds" head to blade. Also available in 54" length.

| Catalog Number | Size | Graduations | Pack   |
|----------------|------|-------------|--------|
| JTS48HD        | 48"  | 1/8"        | 2/pack |
| JTS481HD       | 48"  | 1/8"        | 1/pack |
| JTS54HD        | 54"  | 1/8"        | 2/pack |



## CONTRACTOR

### ROCKRIPPER. DRYWALL SCORING SQUARES

*Construction:* Foam-molded high impact plastic head. Insert-molded, perforated aluminum blade to accept utility knife point for scoring drywall. Screened increments in 1/16" or mm. Black thermal bonded graduations.

| Catalog Number | Size  | Graduations |
|----------------|-------|-------------|
| RTS24          | 24"   | 1/16"       |
| RTS24M         | 630mm | mm          |

U.S. Patent No. 6,070,331

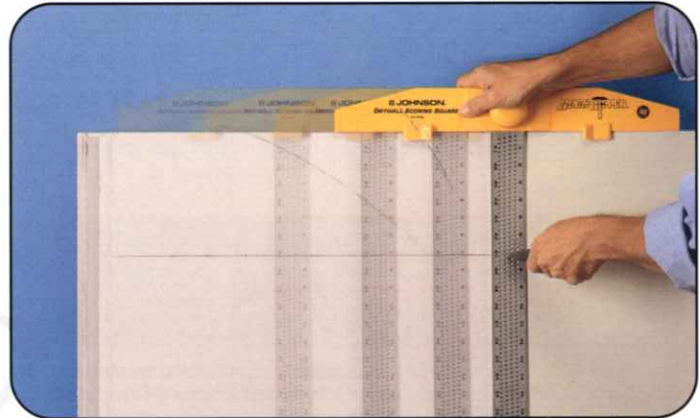



# RULES & STRAIGHT EDGES

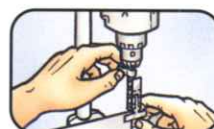
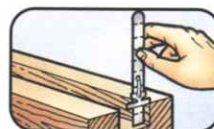
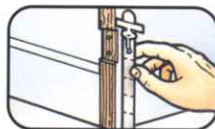

## CONTRACTOR POCKET CLIP RULES

*Construction:* Stainless steel with etched increments in  $1/32$ nds and  $1/64$ ths. Metric Clip Rule available in mm.

| Catalog Number | Length | Width | Thickness | Graduations  |
|----------------|--------|-------|-----------|--------------|
| 7202           | 6"     | 1/2"  | .020"     | 1/32", 1/64" |
| 7203           | 6"     | 1/2"  | .020"     | 1/64", mm    |



## ALUMINUM RULES

*Construction:* Extruded aluminum with clear (silver) anodized finish. Screened thermal bonded black graduations in  $1/8$ ths and  $1/16$ ths.

| Catalog Number | Length | Width  | Thickness | Graduations |
|----------------|--------|--------|-----------|-------------|
| J112           | 12"    | 1 1/8" | .075"     | 1/8", 1/16" |
| J118           | 18"    | 1 1/8" | .075"     | 1/8", 1/16" |
| J124           | 24"    | 1 1/8" | .075"     | 1/8", 1/16" |



## ALUMINUM YARDSTICK

*Construction:* Extruded aluminum with clear (silver) anodized finish. Screened thermal bonded black graduations in  $1/8$ ths and  $1/16$ ths.

| Catalog Number | Length | Width  | Thickness | Graduations |
|----------------|--------|--------|-----------|-------------|
| J236           | 36"    | 1 1/8" | .075"     | 1/8", 1/16" |



## ALUMINUM METERSTICK

*Construction:* Extruded aluminum with clear (silver) anodized finish. Screened thermal bonded black graduations in  $1/8$ ths and mm.

| Catalog Number | Length  | Width  | Thickness | Graduations |
|----------------|---------|--------|-----------|-------------|
| M391           | 1 Meter | 1 1/8" | .075"     | 1/8", mm    |



## METRIC ALUMINUM METERSTICK

*Construction:* Extruded aluminum with clear (silver) anodized finish. Screened thermal bonded black graduations in mm.

| Catalog Number | Length  | Width  | Thickness | Graduations |
|----------------|---------|--------|-----------|-------------|
| 3900           | 1 Meter | 1 1/8" | .075"     | mm          |

# RULES & STRAIGHT EDGES

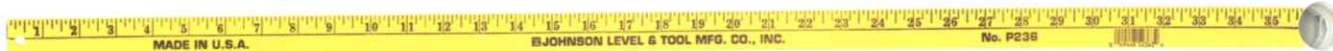

## PVC YARDSTICK

*Construction:* Extruded flexible PVC yellow plastic with black printed graduations in  $\frac{1}{8}$ ths on both sides.

| Catalog Number | Length | Width  | Thickness | Graduations |
|----------------|--------|--------|-----------|-------------|
| P236           | 36"    | 1 1/8" | .125"     | 1/8"        |



## WOOD YARDSTICK

*Construction:* American softwood species. Black printed graduations in  $\frac{1}{8}$ ths on both sides.

| Catalog Number | Length | Width  | Thickness | Graduations |
|----------------|--------|--------|-----------|-------------|
| W236           | 36"    | 1 1/8" | .125"     | 1/8"        |



## ALUMINUM STRAIGHT EDGES

*Construction:* Extruded aluminum with clear (silver) anodized finish. Screened thermal bonded black graduations in  $\frac{1}{8}$ ths and  $\frac{1}{16}$ ths. Also available in metric [ $\frac{1}{8}$ ths,  $\frac{1}{16}$ ths and mm].

| Catalog Number | Length | Width | Thickness | Graduations     |
|----------------|--------|-------|-----------|-----------------|
| J18            | 18"    | 2"    | .110"     | 1/8", 1/16"     |
| J24            | 24"    | 2"    | .110"     | 1/8", 1/16"     |
| J24EM          | 24"    | 2"    | .110"     | 1/8", 1/16", mm |
| J36            | 36"    | 2"    | .110"     | 1/8", 1/16"     |
| J36EM          | 36"    | 2"    | .110"     | 1/8", 1/16", mm |
| J48            | 48"    | 2"    | .110"     | 1/8", 1/16"     |
| J48EM          | 48"    | 2"    | .110"     | 1/8", 1/16", mm |
| J60            | 60"    | 2"    | .125"     | 1/8", 1/16"     |
| J60EM          | 60"    | 2"    | .125"     | 1/8", 1/16", mm |
| J72            | 72"    | 2"    | .125"     | 1/8", 1/16"     |
| J72EM          | 72"    | 2"    | .125"     | 1/8", 1/16", mm |
| J96            | 96"    | 2"    | .125"     | 1/8", 1/16"     |



## ALUMINUM CUTTING GUIDE

*Construction:* Two 49" extruded aluminum rails with patented quick-to-assemble connector. Comes with two "c" clamps. Use with circular saws or routers for accurate cuts over long distances.

| Catalog Number | Length |
|----------------|--------|
| J4900          | 98"    |

U.S. Patent No. 5,138,759  
Canadian Patent No. 2,074,160



# PLUMB BOBS & SAWS



**CONTRACTOR**  
**BRASS PLUMB BOBS**

*Construction:* Machined brass with lacquer finish. Replaceable hardened steel tip. Removable cap for easy, centered string installation.

| Catalog Number | Weight |
|----------------|--------|
| 108            | 8 oz.  |
| 112            | 12 oz. |
| 116            | 16 oz. |
| 124            | 24 oz. |
| 132            | 32 oz. |



**PROJECT**  
**STEEL PLUMB BOBS**

*Construction:* Machined hexagonal steel with bright plated finish. Removable top for easy, centered string installation.

| Catalog Number | Weight |
|----------------|--------|
| 05             | 5 oz.  |
| 08             | 8 oz.  |
| 012            | 12 oz. |



**WALL BOARD SAW**

*Construction:* Hardwood handle with lacquer finish. Steel blade with sharp teeth and rust protective finish.

| Catalog Number | Size            |
|----------------|-----------------|
| 68             | 11 1/4" overall |



**MINI HACK SAW**

*Construction:* High impact plastic molded handle. Accepts any hacksaw blade, including broken ones.

| Catalog Number | Size         |
|----------------|--------------|
| 60             | 9" w/o blade |

U.S. Patent No. D291,962



| Catalog Number | Size   |
|----------------|--------|
| 2035           | 3 1/2" |
| 2040           | 4"     |

## BUTT MARKERS

*Construction:* Hardened stamped steel with ground chisel edges. Built in depth scriber.

*Applications:* A quick and accurate way to mount butt hinges on door and jam. Cuts profile of hinge – then mortise cavity with wood chisel.



| Catalog Number | Size |
|----------------|------|
| 2206           | 6"   |

## PROJECT

### CONTOUR GAUGE

*Construction:* Stamped steel body with ruled edge. Stainless steel contour wires form around any shape.

*Applications:* Obtains and replicates odd angles and shapes for tiling, finish carpentry, wood working, flooring, carpeting.

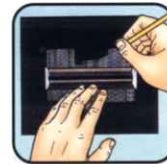
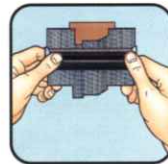

| Catalog Number | Size            |
|----------------|-----------------|
| 60-275         | 5 1/2" x 3 1/2" |

U.S. Patent No. 4,955,142

## PROJECT

### DECK-MATE® BOARD SPACING TOOL

*Construction:* Durable high impact plastic body. 1/8" or 3/16" spacer. Nail/screw layout guide for 2" x 6" or 2" x 4".

*Applications:* Evenly spaces dry or "green" deck lumber. Won't fall through cracks. Ideal for polymer decking which must be accurately spaced.





# CRAYONS & PENCILS

## CONTRACTOR TRU-LINE LUMBER CRAYONS

Available in four colors. Two per blister card.  
Lead-free, nontoxic, weather and fade resistant.  
Fits Peterson holder.

| Catalog Number | Color  |
|----------------|--------|
| 3502-Y         | Yellow |
| 3502-R         | Red    |
| 3502-K         | Black  |
| 3502-B         | Blue   |



## CONTRACTOR TRU-LINE LUMBER CRAYONS

Available in four colors. Twelve per box.  
Lead-free, nontoxic, weather and fade resistant.  
Fits Peterson holder.

| Catalog Number | Color  |
|----------------|--------|
| 3512-Y         | Yellow |
| 3512-R         | Red    |
| 3512-K         | Black  |
| 3512-B         | Blue   |



## PROJECT TRU-LINE CARPENTER PENCILS

American wood from renewable forests with medium graphite lead. Flat design will not roll. Two per blister card, twelve or seventy-two per box.

| Catalog Number | Pack   |
|----------------|--------|
| CP             | 2/Card |
| CPB-12         | 12/Box |
| CPB-72         | 72/Box |



## CONTRACTOR INSTA-MARK CARPENTER PENCIL

High impact plastic body with metal pocket clip.  
Convenient storage chamber holds three spare leads (furnished). Lead advances and retracts with the flick-of-a-thumb. Eliminates need to sharpen carpenter pencil.  
Additional replacement lead available separately.

| Catalog Number | Item                     |
|----------------|--------------------------|
| 3400           | "Insta-Mark" Pencil      |
| 3410           | 10/pack Replacement Lead |

U.S. Patent No. 5,044,805  
Canadian Patent No. 2,016,909

# FLAGS & TAPES

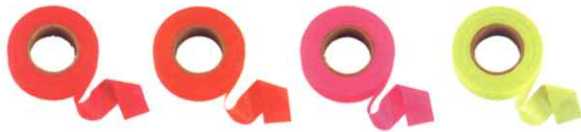

## GLO FLAGGING TAPE

Durable plastic. Available in vibrant glo colors.

| Catalog Number | Length    | Color      |
|----------------|-----------|------------|
| 3301-R         | 1" x 200' | Glo-Red    |
| 3301-O         | 1" x 200' | Glo-Orange |
| 3301-P         | 1" x 200' | Glo-Pink   |
| 3301-L         | 1" x 200' | Glo-Lime   |



## FLAGGING TAPE

Durable plastic. Available in vibrant colors.

| Catalog Number | Length         | Color  |
|----------------|----------------|--------|
| 3311-R         | 1 3/16" x 300' | Red    |
| 3311-Y         | 1 3/16" x 300' | Yellow |
| 3311-B         | 1 3/16" x 300' | Blue   |
| 3311-G         | 1 3/16" x 300' | Green  |



## BARRICADE TAPE

Durable plastic with heavily-pigmented black ink. Available in yellow or red colors.

| Catalog Number | Length     | Color / Message           |
|----------------|------------|---------------------------|
| 3321           | 3" x 300'  | Yellow "Caution"          |
| 3324           | 3" x 1000' | Yellow "Caution"          |
| 3322           | 3" x 300'  | Red "Danger Do Not Enter" |
| 3323           | 3" x 300'  | Yellow "Wet Paint"        |

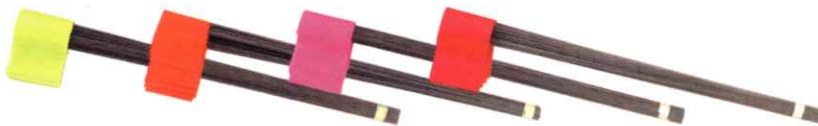

## STAKE FLAGS

2.5" x 3.5" poly flag mounted on 21" wire staff (0.62" diameter). Available in multiple colors.

| Catalog Number | Pack       | Color      |
|----------------|------------|------------|
| 3350-L         | 100/Bundle | Glo-Lime   |
| 3350-O         | 100/Bundle | Glo-Orange |
| 3350-P         | 100/Bundle | Glo-Pink   |
| 3350-R         | 100/Bundle | Glo-Red    |







**JT** **JOHNSON**<sup>®</sup>  
*LEVEL & TOOL*

6333 West Donges Bay Road, Mequon, WI 53092-4456 USA 262/242-1161 Fax 262/242-0189  
[www.johnsonlevel.com](http://www.johnsonlevel.com)