



Tiling Laser
Model No. 40-6624



Instruction Manual

Congratulations on your choice of this Tiling Laser. We suggest you read this instruction manual thoroughly before using the instrument and save this instruction manual for future use.

This is a Class II laser tool and is manufactured to comply with CRF 21, parts 1040.10 and 1040.11 as well as international safety rule IEC 285.



Table of Contents

- | | |
|------------------------------------------|-----------------------------|
| 1. Features and Functions | 5. Operating Instructions |
| 2. Safety Instructions | 6. Troubleshooting Guide |
| 3. Location/Content
of Warning Labels | 7. Technical Specifications |
| 4. Location of Parts/Components | 8. Product Warranty |
| | 9. Warranty Registration |

1. Features and Functions

This Tiling Laser generates two lines on the floor or wall at 90° angles for layout of tile, stone, brick, carpet and hardwood flooring. The laser beams project over wet mastic or concrete. Angles are easily established with the built-in protractor.





2. Safety Instructions

Please read and understand all of the following instructions, prior to using this tool. Failure to do so, may void the warranty.

DANGER!

Class II Laser Product
Max. Power Output: $\leq 1\text{mW}$
Wavelength: 635nm

**THIS TOOL EMITS LASER RADIATION.
DO NOT STARE INTO BEAM.
AVOID DIRECT EYE EXPOSURE.**



ATTENTION



IMPORTANT

- Read all instructions prior to operating this laser tool. Do not remove any labels from tool.
- Do not stare directly at the laser beam.
- Do not project the laser beam directly into the eyes of others.
- Do not set up laser tool at eye level or operate the tool near a reflective surface as the laser beam could be projected into your eyes or into the eyes of others.
- Do not place the laser tool in a manner that may cause someone to unintentionally look into the laser beam. Serious eye injury may result.
- Do not operate the tool in explosive environments, i.e. in the presence of gases or flammable liquids.
- Keep the laser tool out of the reach of children and other untrained persons.
- Do not attempt to view the laser beam through optical tools such as telescopes as serious eye injury may result.
- Always turn the laser tool off when not in use or left unattended for a period of time.
- Remove the batteries when storing the tool for an extended time (more than 3 months) to avoid damage to the tool should the batteries deteriorate.
- Do not attempt to repair or disassemble the laser tool. If unqualified persons attempt to repair this tool, warranty will be void.
- Use only original Johnson® parts and accessories purchased from your Johnson® authorized dealer. Use of non-Johnson® parts and accessories will void warranty.



3. Location/Content of Warning Labels

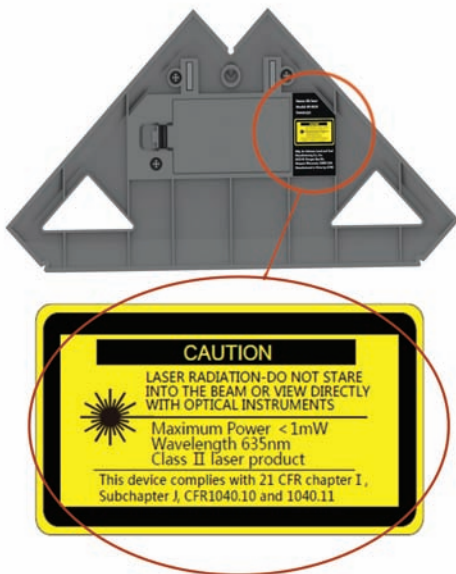



4. Location of Parts/Components



5. Operating Instructions

IMPORTANT: It is the responsibility of the user to ensure proper maintenance of the Tiling Laser. Conduct periodic test measurements to ensure the instrument is measuring accurately and consistently. This is most important if the instrument has been exposed to extreme temperatures or moisture. Keep the Tiling Laser optic lens clean and inspect for damage.

Battery Installation

To install batteries in the Tiling Laser:

1. Remove the battery cover, which is located on the bottom of the tool.
2. Insert 2 “AA” batteries into the battery compartment according to the polarity illustrated inside.
3. Replace the battery cover.



Notes:

- Use only alkaline batteries.
- Remove the batteries when storing the instrument for an extended time (more than 3 months) to avoid damage to the tool should the batteries deteriorate.



Using the Product

1. Press the power button to power on the tool, and it will emit two laser beams.
2. Position the laser so that it is appropriate to your application needs. Follow a reference line or, if necessary, align the laser beams with reference points.
3. Use the laser beams as the new reference lines, since they can be seen over mastic or floor coatings.
4. To power off the tool, press the power button.





Tips from the Pros

- Increasing the Beams' Visibility – When working in bright conditions, such as when working near windows or outside walls, the visibility of the laser beams can be maximized by following these steps:
 - Work towards the laser.
 - Use a freestanding target (sold separately).
 - Wear laser glasses (sold separately).

Note: Laser glasses enhance beam visibility but should never be used to stare into the beam or be used as safety glasses. Eye damage may result if these directions are not followed.

- Use fresh batteries.
- Always mark to the center of the laser line. The width may change, but the center location is always collinear to the Tiling Laser.
- When using the Tiling Laser on the floor, do not mark reference lines that project onto walls. If the floor is not perfectly level, these lines will not be plumb.





Care and Handling

- This Tiling Laser is a precision tool that must be handled with care.
- Avoid exposing unit to shock vibrations and extreme temperatures.
- Remove the batteries when storing the unit for an extended time (more than 3 months) to avoid damage to the unit should the batteries deteriorate.
- Avoid getting the unit wet.
- Keep the laser unit dry and clean, especially the laser output window. Remove any moisture or dirt with a soft, dry cloth.
- Do not use harsh chemicals, strong detergents or cleaning solvents to clean the unit.





6. Troubleshooting Guide

This section is designed to help you diagnose and troubleshoot common problems that prevent the Tiling Laser from working properly.

Symptom	Possible Cause	Solution
Will not turn on	Batteries missing or depleted	Change the batteries
	Polarity reversed	Check battery polarity
Turns off after a short time	Batteries depleted	Change the batteries
Laser light is dim	Batteries depleted	Change the batteries





7. Technical Specifications

Laser Wavelength	635 nm
Laser Classification	II
Maximum Power Output	≤1mW
Laser Accuracy	±1/4" / 20'
Measuring Range	0' - 23'
Power Supply	2 "AA" alkaline batteries (included)
Battery Life	20 hours
Operating Temperature Range	32°F - 104°F
Storage Temperature Range	0°F - 120°F
Dimensions	8.5" x 2.0" x 4.0"
Weight	0.385 lbs.
IP Rating	IP 50





8. Product Warranty

Johnson Level & Tool offers a two year limited warranty on each of its products. You can obtain a copy of the limited warranty for a Johnson Level & Tool product by contacting Johnson Level & Tool's Customer Service Department, as provided below, or by visiting our web site at www.johnsonlevel.com. The limited warranty for each product contains various limitations and exclusions.

Do not return this product to the store/retailer or place of purchase. Non-warranty repairs and course calibration must be done by an authorized Johnson® service center or Johnson Level & Tool's limited warranty, if applicable, will be void and there will be NO WARRANTY. Contact one of our service centers for all non-warranty repairs. A list of service centers can be found on our web site at www.johnsonlevel.com or by calling our Customer Service Department. Contact our Customer Service Department for Return Material Authorization (RMA) for warranty repairs (manufacturing defects only). Proof of purchase is required.

NOTE: The user is responsible for the proper use and care of the product. It is the responsibility of the user to verify the calibration of the instrument before each use.

For further assistance, or if you experience problems with this product that are not addressed in this instruction manual, please contact our Customer Service Dept.

In the U.S., contact Johnson Level & Tool's Customer Service Department at 888-9-LEVELS.

In Canada, contact Johnson Level & Tool's Customer Service Department at 800-346-6682.





9. Warranty Registration

Please register within 30 days of purchase. Registering ensures we have your information on file for warranty service even if you lose your receipt, and lets us contact you if there is ever a product recall. We will never sell your information and only send you marketing information if you opt-in.

To register, go to www.johnsonlevel.com/register.



